

H.M. LAND REGISTRY		TITLE NUMBER	
		HD35275	
ORDNANCE SURVEY PLAN REFERENCE	TL 2031.	SECTION B	1/
COUNTY HERTFORDSHIRE.	DISTRICT NORTH HERTFORDSHIRE.	© Crown	

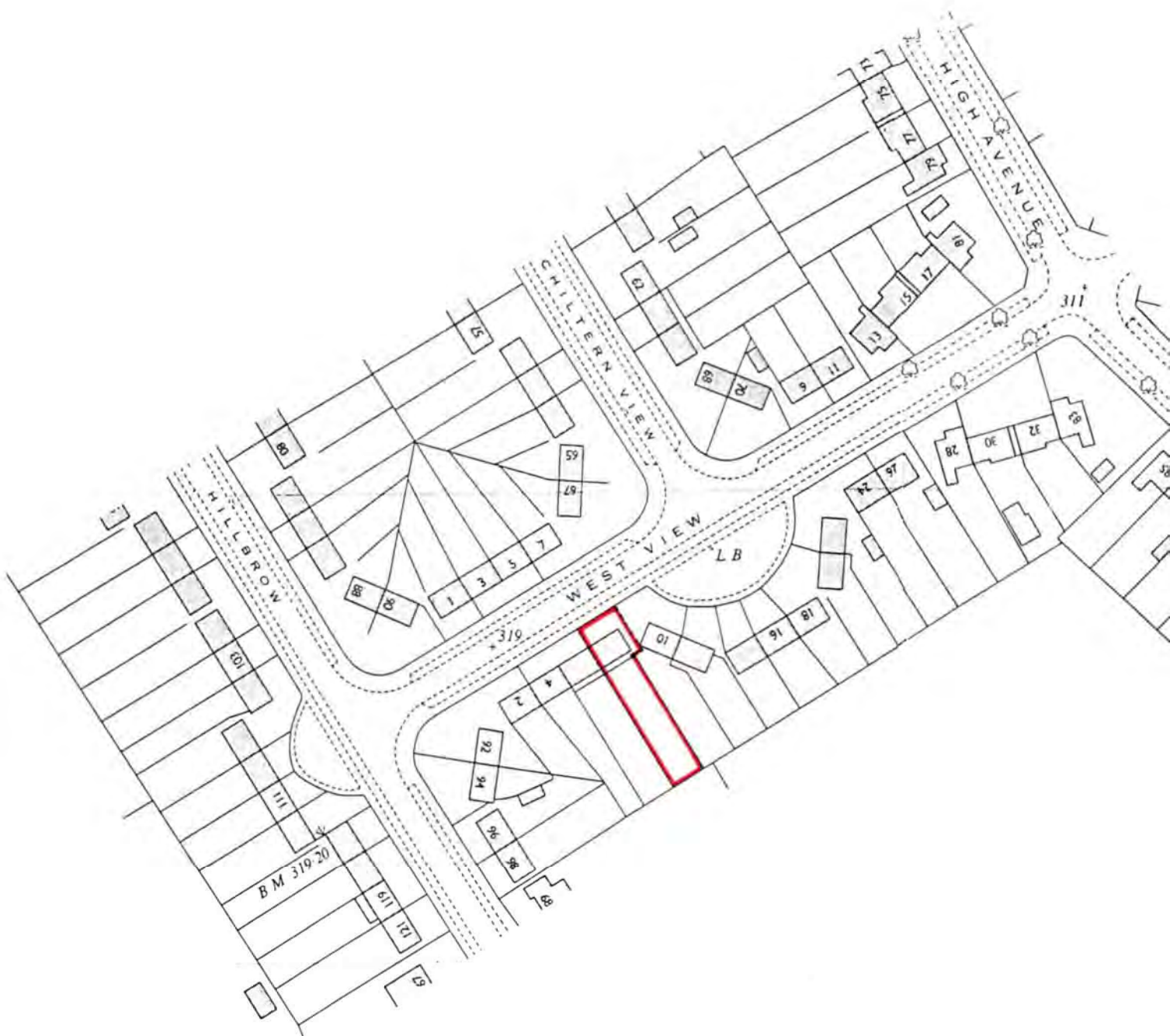



2M distance from the line where gate post is

Starting from this point 4m of dropped kerb is required towards right hand-side

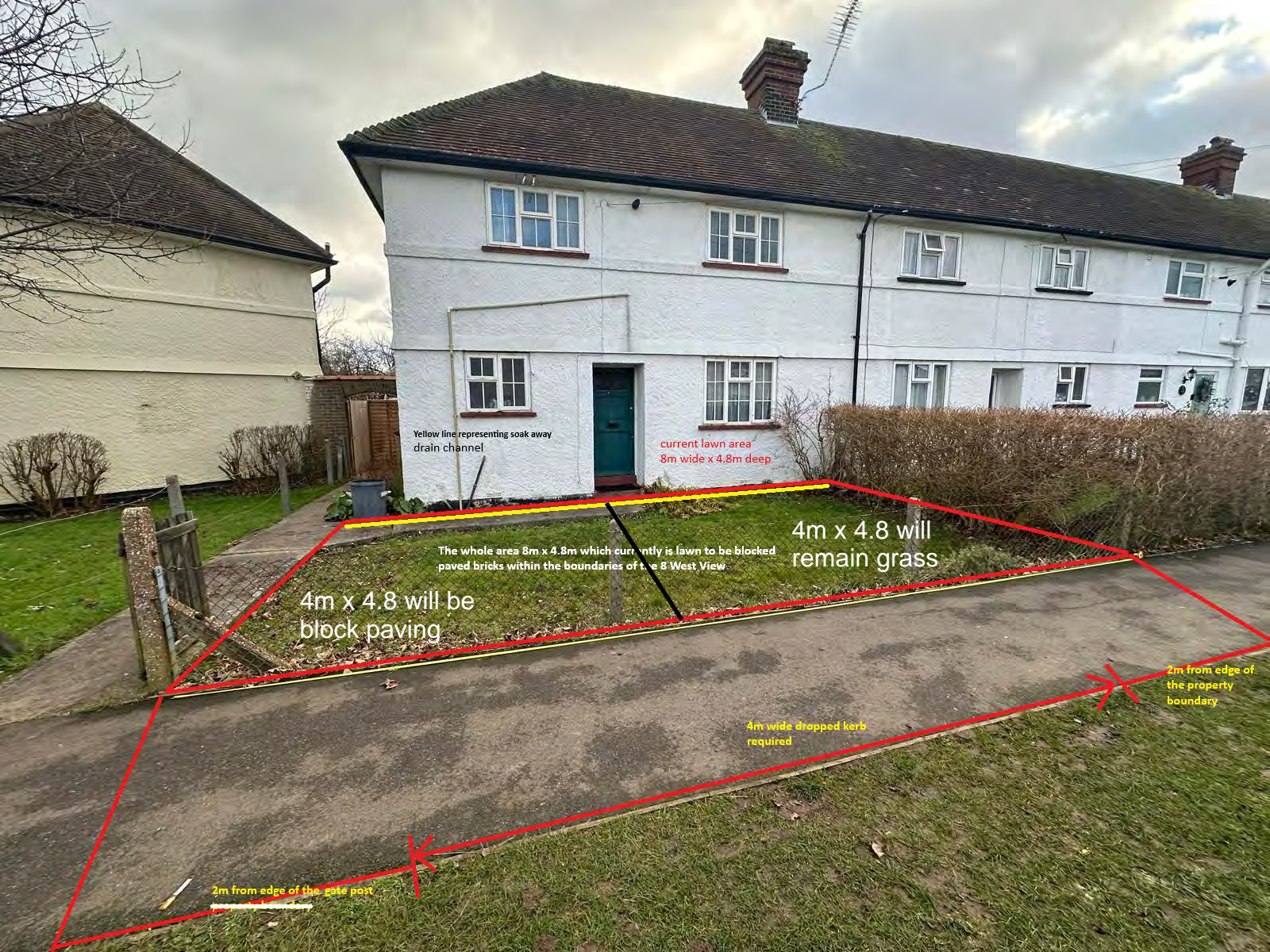

Yellow line representing soak away drain channel

current lawn area
3m wide x 4.8m deep

The whole area 8m x 4.8m which currently is lawn to be blocked paved bricks within the boundaries of the 8 West View

4m x 4.8 will remain grass

4m x 4.8 will be block paving

4m wide dropped kerb required

2m from edge of the property boundary

2m from edge of the gate post